

SITE CLEARING CONTRACTOR TO HAVE SITE MEETING WITH ESC SUPERVISOR PRIOR TO CLEARING SITE.

CLEARING, ROAD STRIPPING, GRAVELLING AND ROUGH GRADING STAGE.

- CONTRACTOR TO FOLLOW MOTI BEST MANAGEMENT PRACTICES. REFER TO SECTION 165 "PROTECTION OF THE ENVIRONMENT" OF THE 2020 STANDARD SPECIFICATIONS FOR HIGHWAY CONSTRUCTION.
- CONTRACTOR TO PROVIDE A CONSTRUCTION ENVIRONMENTAL MANAGEMENT PLAN AS PER SECTION 165.02.02 OF THE 2020 STANDARD SPECIFICATIONS OF HIGHWAY CONSTRUCTION.
- CONTRACTOR TO NOTIFY THE ENGINEER OF RECORD THAT CLEARING AND GRUBBING HAS COMMENCED.
- CONTRACTOR TO NOTIFY BOTH THE ENGINEER OF RECORD THAT CLEARING AND GRUBBING HAS COMMENCED. CONTRACTOR TO FOLLOW MOTI BEST MANAGEMENT PRACTICES. REFER TO THE EROSION AND SEDIMENT CONTROL MANUAL (2022) AND ESC DRAWING.
- SITE CLEARING AND GRUBBING CONTRACTOR TO CONFIRM ESC PERMIT HAS BEEN ISSUED, THERE IS A COPY ON SITE, AND THE PERMIT SIGNAGE IS ERECTED AT THE SITE ENTRANCE.
- THE CLEARING AND GRUBBING CONTRACTOR WILL CONTACT A PROFESSIONAL ARBORIST TO DISCUSS THE REMOVAL OF HAZARDOUS TREES.
- PERIMETER ESC MEASURES TO BE INSTALLED AFTER MEETING WITH SCRD AS APPLICABLE AND PRIOR TO INITIATING ONSITE CLEARING AND GRUBBING.
- INSTALL PROTECTIVE MEASURES AT OR WITHIN EXISTING CATCH/LAWN BASINS AS APPLICABLE.
- IF EXCESSIVE SEDIMENT IS BEING TRACKED ONTO PUBLIC ROADS, CONTRACTOR TO INSTALL ESC FACILITIES/MEASURES AT ENTRY/EXIT POINTS AND ALL VEHICLE MOVEMENT TO AND FROM THE SITE IS TO BE RESTRICTED TO CONTROLLED ENTRY/EXIT POINTS.
- PRIOR TO LEAVING THE SITE, ON-SITE CLEARING AND GRUBBING CONTRACTOR TO OBTAIN SIGN OFF BY THE ESC SUPERVISOR.
- ANY STOCKPILED MATERIAL TO BE COVERED AND ENCIRCLED BY SEDIMENT FENCE AS SPECIFIED.
- THE CONTRACTOR WILL BE RESPONSIBLE TO ENSURE THAT THE EXISTING ROADS ARE REVIEWED DAILY AND SWEEPED REGULARLY. FLUSHING OF ROADWAYS IS PROHIBITED.
- AFTER ROUGH LOT GRADING IS COMPLETED ALL DISTURBED AREAS ARE TO BE PROTECTED AS PER THE ESC PLAN.
- UPON THE COMMENCEMENT OF WORKS, THE ESC SUPERVISOR IS TO CONDUCT MONITORING AS PER THE DISTRICTS MONITORING AND REPORTING REQUIREMENTS.

ALL DISTURBED AREAS SHALL BE STABILIZED IMMEDIATELY UPON COMPLETION OF ROUGH GRADING. HYDRO SEEDING WILL BE COMPLETED PRIOR TO APPLICATION OF STRAW MULCH. STRAW MULCH TO BE APPLIED AT A RATE OF 4.5 TONNES/Ha. REFER TO LANDSCAPE SPECIFICATIONS FOR HYDROSEEDING

LEGEND

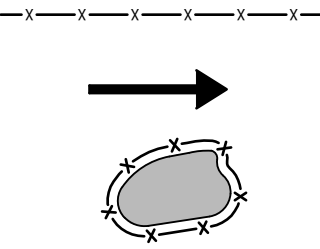

SILT FABRIC FENCE
DIRECTION OF OVERLAND FLOW
COVER ALL TEMPORARY PILES WITH POLY AND SURROUND WITH SILT CONTROL FENCE.

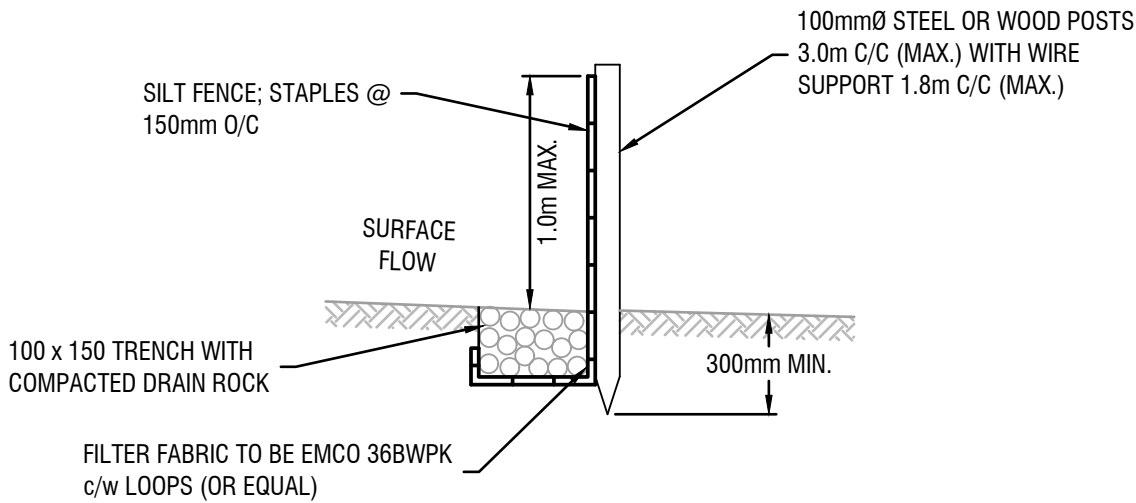

- NOTES:
- SILT FENCE SHALL BE PLACED ON SLOPE CONTOURS TO MAXIMIZE PONDING EFFICIENCY
 - INSPECT AND REPAIR FENCE AFTER EACH STORM EVENT AND REMOVE SEDIMENT WHEN NECESSARY. 225mm MAX. RECOMMENDED STORAGE HEIGHT.
 - REMOVED SEDIMENT SHALL BE DEPOSITED TO AN AREA THAT WILL NOT CONTRIBUTE SEDIMENT OFF-SITE AND CAN BE PERMANENTLY STABILIZED.

TYPICAL SILT FENCE DETAIL
N.T.S.

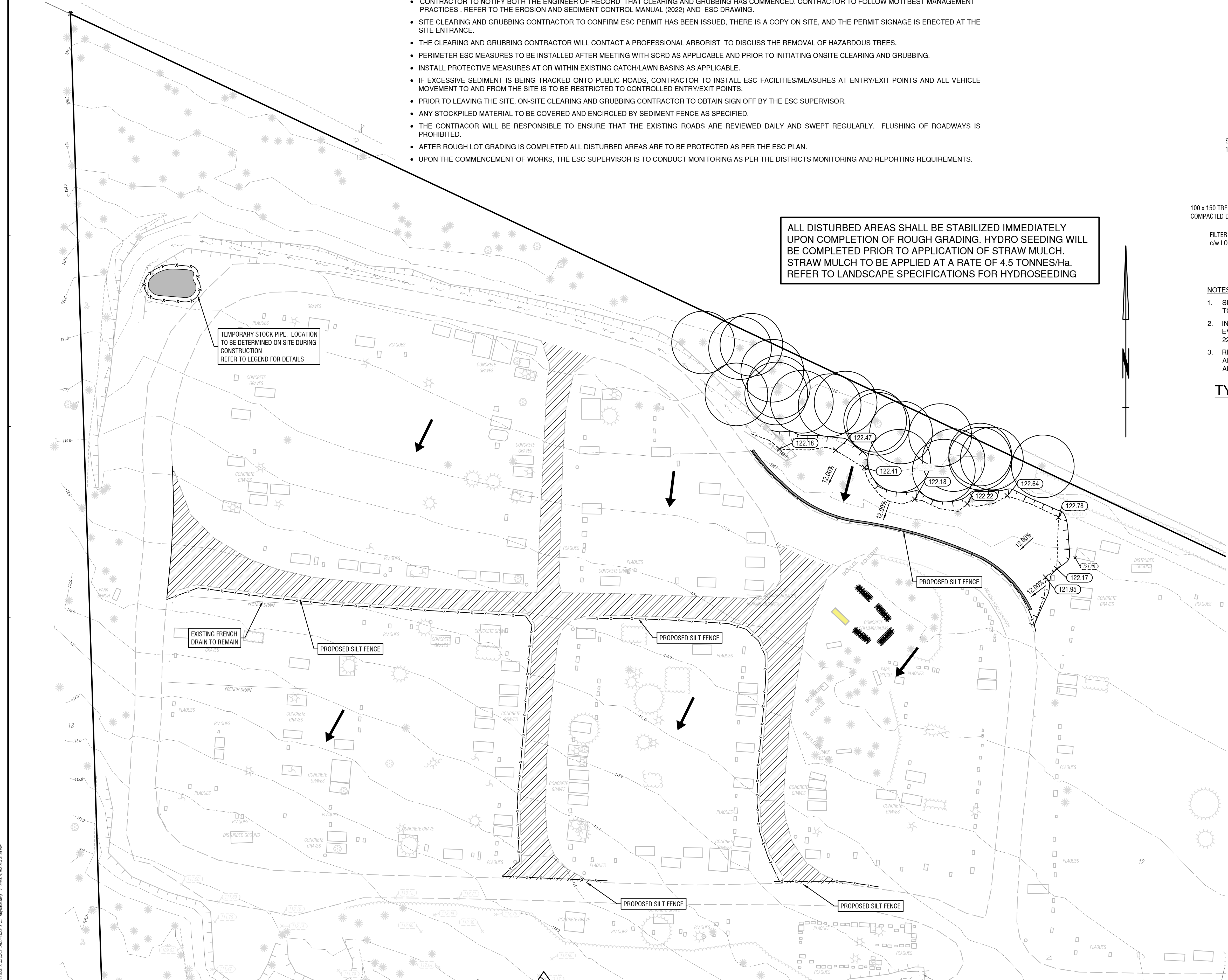

WSP
WSP CANADA INC.
#100 - 20339 96th AVENUE
LANGLEY, B.C.
V1M 0E4 CANADA
TEL. 604-525-4651
www.wsp.com

REV.	DATE	
1	01.31.25	90% DESIGN SUBMISSION
2	03.07.25	100% DESIGN SUBMISSION
3	04.09.25	ISSUED FOR TENDER

CLIENT
**SUNSHINE COAST
REGIONAL
DISTRICT**

PROJECT
**SEAVIEW CEMETERY
LANDSCAPE INFILL**

DRAWING TITLE
**EROSION & SEDIMENT
CONTROL PLAN**

CA0042029.5153	JOB NO.
1:250	SCALE
JAN. 2025	DATE
K.B.	DESIGN
K.B.	DRAWN
2 OF 2	SHEET NO.